

Transportation Notice: Union Canal Elementary School, AM KINDERGARTEN August 2022

Please note the below student transportation map of Union Canal Elementary, **AS OF AUGUST 29, 2022**

- **District Transportation Arrival & Dismissal** (Bus & Vans) will enter the front of the school in the Green Area designated below. Students may enter at the Kindergarten Entrance.
- **Parent/Guardian Transportation** will enter the school at the main parking lot and follow the Red Arrows. All parent/guardian transportation may drop-off and pick up in the areas indicated by yellow below.
 - **AM Drop Off:** 8:45-8:59am. **DO NOT PARK** in the Drop Off/Loading area. Students may enter the building at either the **Main Entrance** or the **Falcons Entrance**. Drop Students and keep moving. If you choose to walk your child to the entrance, please park in the parking lot. Students must be in the building prior to 9:00am.

See Reverse Side For Dismissal

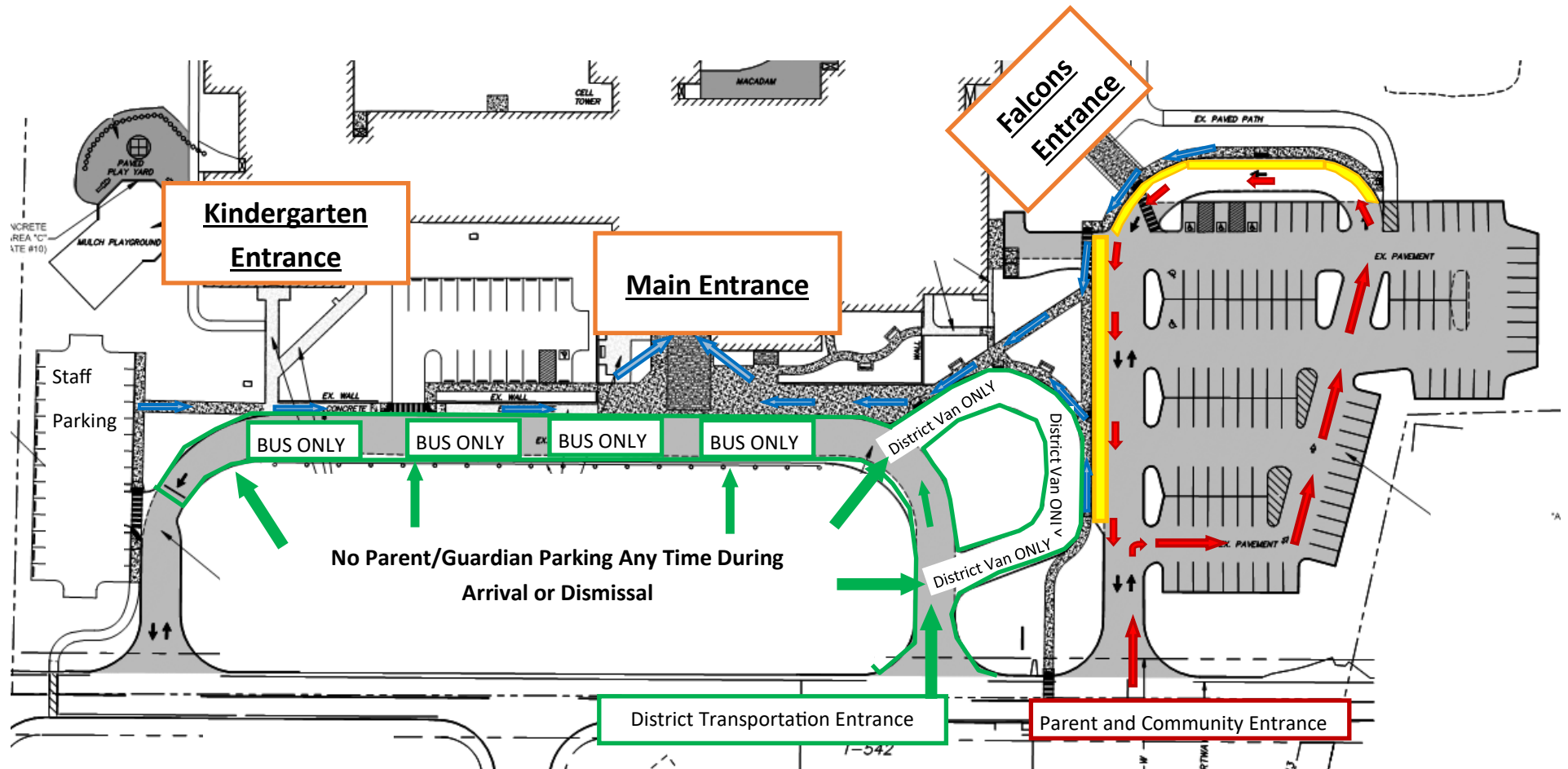

Transportation Notice: Union Canal Elementary School, AM KINDERGARTEN August 2022

Please note the below student transportation map of Union Canal Elementary, **AS OF AUGUST 29, 2022**

- **District Transportation Arrival & Dismissal:** (Bus & Vans) will enter the front of the school in the Green Area designated below. Students will exit at the Kindergarten Entrance onto busses.
- **Parent/Guardian Transportation:** 11:35 Dismissal—Parents enter the school at the main entrance to pick up students.
 - Parent/guardian must have a photo I.D. Parent/Guardian will sign student out in the main office and wait in the main office for students to be dismissed to them.
 - Parents should arrive **No Later Than 11:30am**
 - When picking up student(s) from school ,please notify the teacher/office via note or email the morning of date of dismissal.

See Reverse Side For Arrival

